

## STORAGE POD/ DUMPSTER APPLICATION

NAME OF RESIDENT: \_\_\_\_\_

UNIT #: \_\_\_\_\_ PHONE #: (H) \_\_\_\_\_ (C) \_\_\_\_\_

I WOULD LIKE TO RESERVE FOR :    **STORAGE POD**    or    **DUMPSTER**    (CIRCLE ONE)

☐    DESIGNATED LOCATION 1

☐    DESIGNATED LOCATION 2

☐    DESIGNATED LOCATION 3

START DATE: \_\_\_\_\_

END DATE: \_\_\_\_\_

Maximum duration of 2 weeks

### Rules

#### General

Residents who have been approved to store a dumpster/storage pod on the property shall comply with the following rules.

1. Designated location 1 is the middle visitor parking stall near the carwash area.
2. Designated location 2 is adjacent to the dumpsters located between buildings 211 and 213
3. Designated location 3 is adjacent to the grass near the dumpsters by building 207.
4. POD/DUMPSTER must be contained within the lines of the designated parking stall.
5. POD/DUMPSTER must be located in designated location.
6. The area around the POD/DUMPSTER and the area between the unit and the POD/DUMPSTER must be kept clean and debris free at all times.
7. POD/DUMPSTER placement cannot block or impede use of driveway or other areas of Gateway Peninsula Property.



8. All other rules and regulations outlined in the Gateway Peninsula House Rules apply.

I have read all rules and agree to abide by these and the Gateway Peninsula House Rules.

---

(Signature)

---

(Date)

**ACCEPTED / APPROVED**

---

(Representative, AOA Gateway Peninsula)

---

(Date)



EXISTING FIRE EXTINGUISHER LOCATIONS  
ADDING ADDITIONAL FIRE EXTINGUISHERS

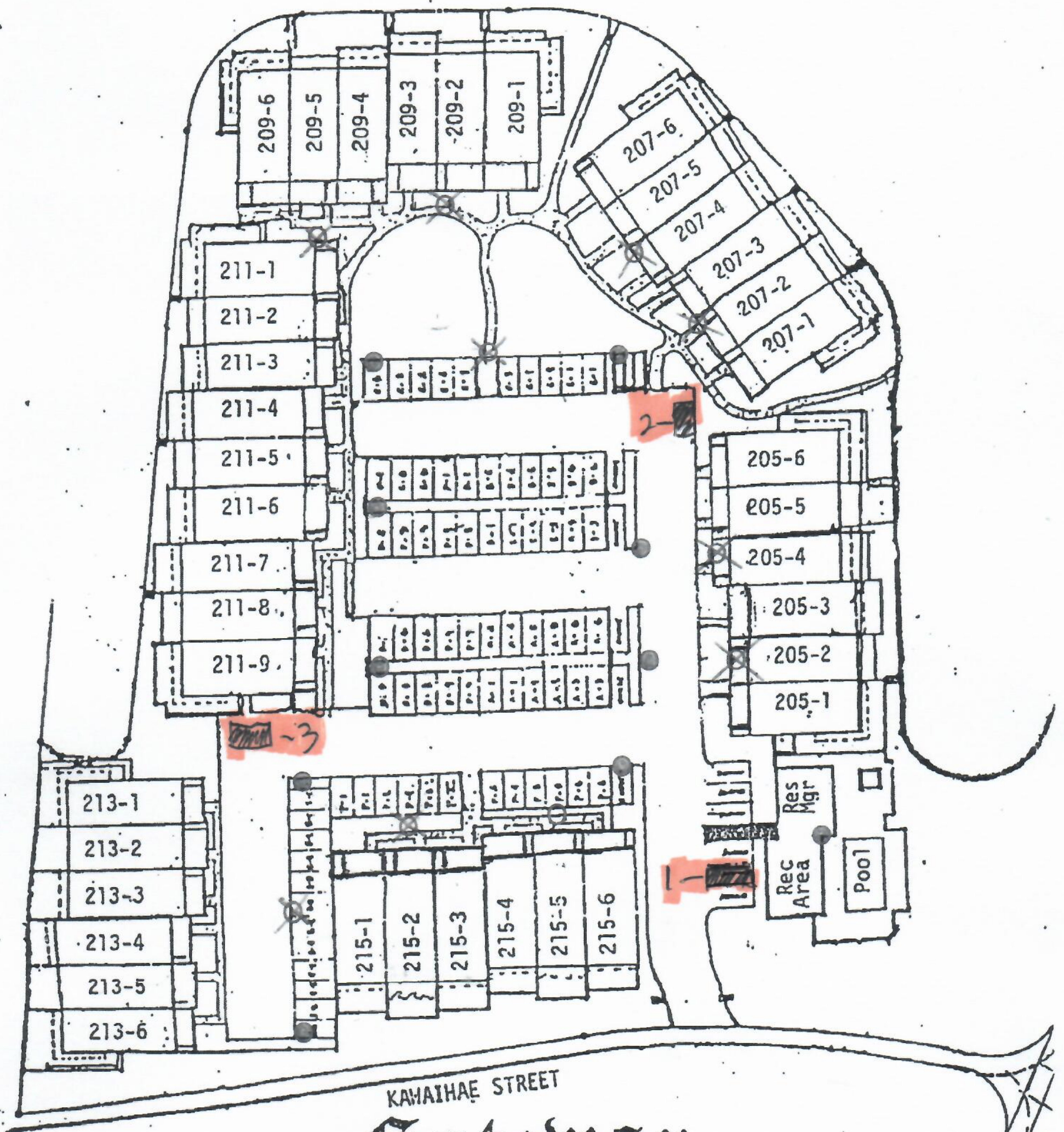

KAWAIHAE STREET

# Gateway Peninsula

NIHILOLI HIGHWAY



