

Residence 104 — ∞ — 1

# LANDMARK

AT WATERFRONT

A Grand Finale on the Water's Edge

# LANDMARK

AT WATERFRONT

128

Life is versatile with the inclusion of a den, which may be used as a home office or extra storage space. A large entryway closet provides even more storage. With each bedroom connected to an ensuite, everyone can enjoy a private sanctuary.



## Plan B

2 BEDROOM, DEN + 2.5 BATH

INTERIOR: 1,230 SF

EXTERIOR: 254 SF

~ BOW RIVER ~

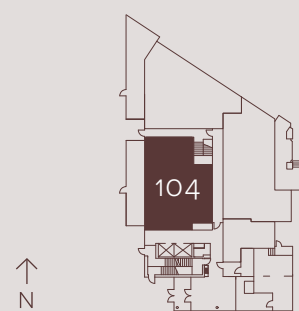

Level 1

The developer reserves the right to make changes and modifications to the information contained herein. Floorplans and floorplates are subject to change without notice. Please contact a developer sales representative for details. The developer may also make such further development modifications as are permitted by the disclosure statement, as may be amended, the contract of purchase and sale between a purchaser and developer (if applicable), or otherwise. E. & O.E.