

# **BUILD IT YOURSELF KIT #33**

- 46X53X8 BASIC SHELL
- PORCHES AS SHOWN
- 6 - 3' HOUSE DOORS
- 8 - 3X5 VINYL WINDOWS
- TRUSSES AT 2' ON CENTER
- STUDS AT 16" ON CENTER
- HOUSE WRAP
- 300' OF INTERIOR FRAMING
- SOFFIT AND FASCIA OVERHANG ON ROOF
- 40 YR WARRANTY 29 GAUGE METAL - 20 COLORS AVAILABLE

➤ *UPGRADE TO OSB & PREMIUM BOARD & BATT METAL SIDING AVAILABLE*

WE DELIVER UP TO 5 HOURS FROM POCAHONTAS, ARKANSAS.

\*PLUS TAX & DELIVERY

ADDITIONAL FEES AND SURCHARGES MAY APPLY. PRICES ARE SUBJECT TO CHANGE WITHOUT NOTICE.

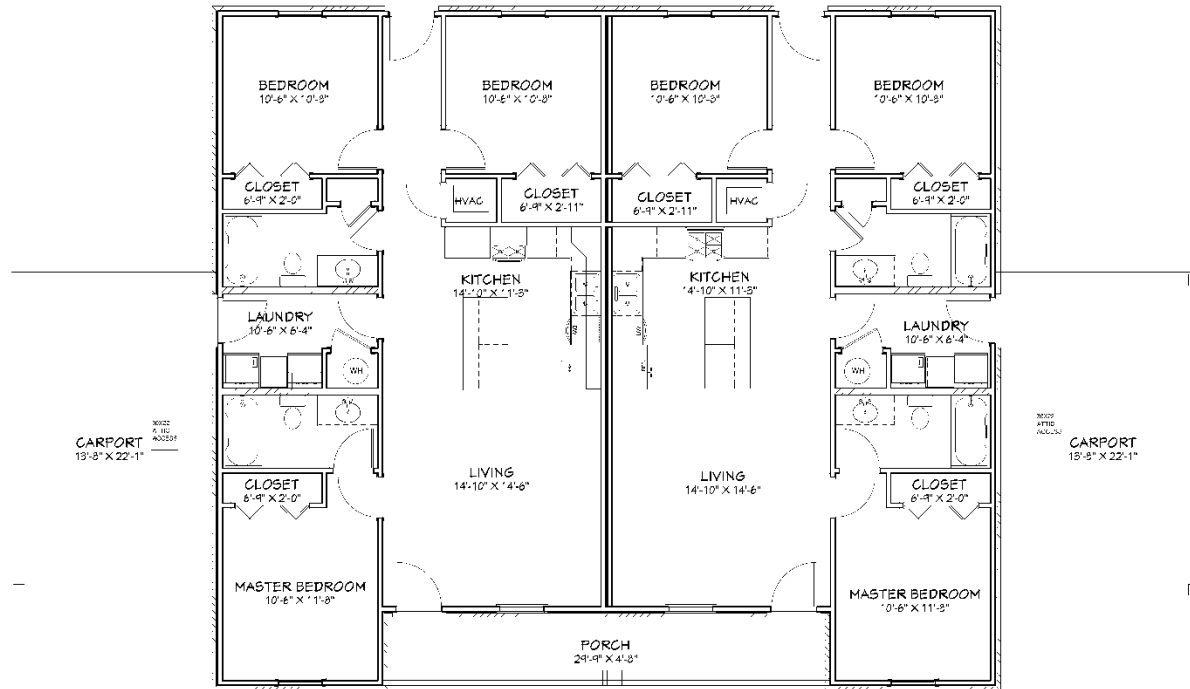

ALL CEILING 8 FT



EACH UNIT	
Living Area	1129 sf
Porch	77 sf
Carport	310 sf
Total Slsb Str H	
	3032 sf

PLAN NO.  
 PLAN DATE  
 PLAN NO.  
 PLAN DATE  
 PLAN NO.  
 PLAN DATE  
 PLAN NO.  
 PLAN DATE

PLAN VIEW

OVERMAN BUILDINGS  
Plan #33

CLIENT:

DRAWINGS PROVIDED BY:  
 Overman Buildings  
 1100 Park St.,  
 Piquette, AL 36069  
 205-607-1900

DATE:  
 7/21/2020

SCALE:  
 1/4"=1'

SHEET:

A-1