

BUILD IT YOURSELF KIT #10B

- 36X50X8 BASIC SHELL
- PORCH AS SHOWN
- 2 - 3' HOUSE DOORS
- 5 - 3X5 VINYL WINDOWS
- 1 – 3X3 VINYL WINDOW
- TRUSSES AT 2' ON CENTER
- STUDS AT 16" ON CENTER
- HOUSE WRAP
- 209' OF INTERIOR FRAMING
- SOFFIT AND FASCIA OVERHANG ON ROOF
- 40 YR WARRANTY 29 GAUGE METAL - 20 COLORS AVAILABLE

➤ *UPGRADE TO OSB & PREMIUM BOARD & BATT METAL SIDING AVAILABLE*

WE DELIVER UP TO 5 HOURS FROM POCAHONTAS, ARKANSAS.

*PLUS TAX & DELIVERY

ADDITIONAL FEES AND SURCHARGES MAY APPLY. PRICES ARE SUBJECT TO CHANGE WITHOUT NOTICE.

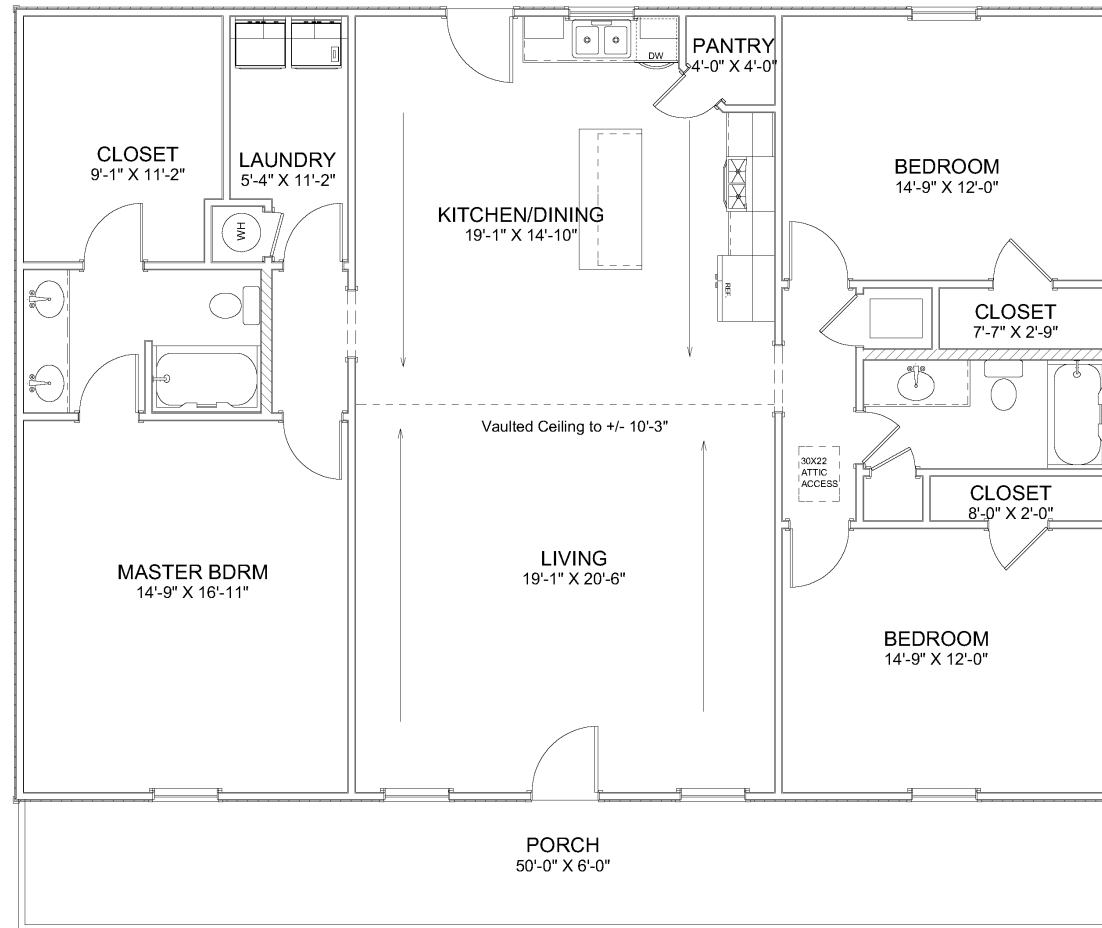

8 ft Ceilings Unless Noted



Living Area	1800 sf
Porch	300 sf
Total Under Roof	2100 sf

SHEET TITLE:
PLAN VIEW

PROJECT DESCRIPTION:
**Overman Plan #2021-10B
Full Porch w/ Gable**

DRAWINGS PROVIDED BY:
Overman Buildings
1100 Park Rd.
Pocahontas, AR 72455
870-669-1500

DATE:
4/22/2021

SCALE:
Scale @ 1/8"=1'-0"
1/4" = 1'

SHEET:
A-1