

Spring 2020 Coastal Newsletter

Duncan Mellor Joins Civilworks NE

Duncan brings 34 years of specialized experience in coastal and waterfront engineering assessment and design to Civilworks New England. This is a natural fit as he and Steve Haight have teamed on many waterfront and coastal projects for almost 20 years. Duncan has extensive experience includes a solid technical background in civil and ocean engineering, used assessments (above and underwater), design, permitting and construction of structures along shorelines, waterways, ports and harbors. This includes piers, wharves, seawalls, bulkheads, quay walls, revetments, breakwaters, groins, dams, bridges, parks, marinas, dredging & dredge material beneficial reuse, beach nourishment, and even unique projects such as tidal turbines, offshore structures, lighthouses, historic structures, frequently involving creative solutions. He is licensed in civil, structural, and geotechnical engineering and is a certified commercial diver/engineer.



What is Happening with Sea Level Rise?

We continue to track the latest journal papers and sea level rise data, measured by tide gauges and satellites. This is of critical importance for those close to the sea and computer projections show a wide range of future conditions. Observations of sea level rise remain linear, not accelerating, and are typically lower currently compared to many of the computer models at a linear rise of about 11 inches per 100 years based on data over the last 3 decades.

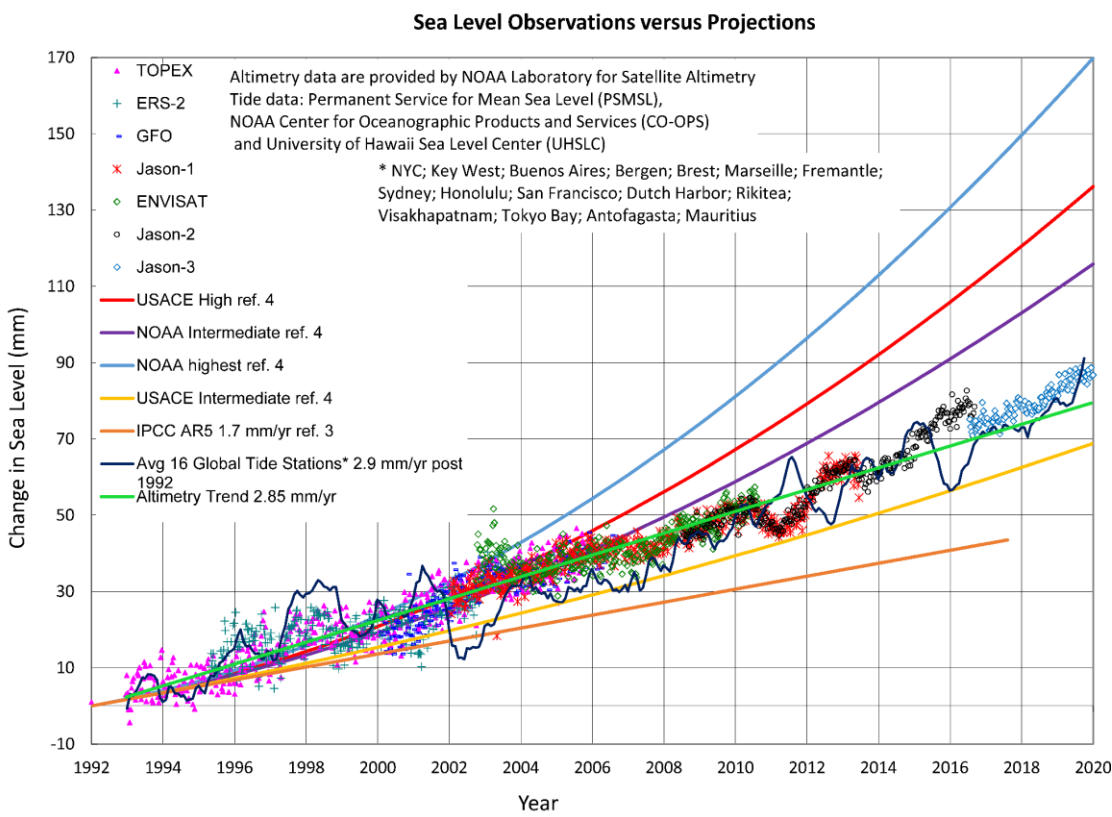

Seacoast Sustainability: New C&J Trailways Bus Terminal

A Civilworks designed and permitted new bus terminal is under construction in Seabrook! The popular bus connection to Boston for commuters and travelers often has full parking lots at several seacoast bus terminals and the new terminal on Route 107 in Seabrook (next to I95) is sure to be a popular addition.

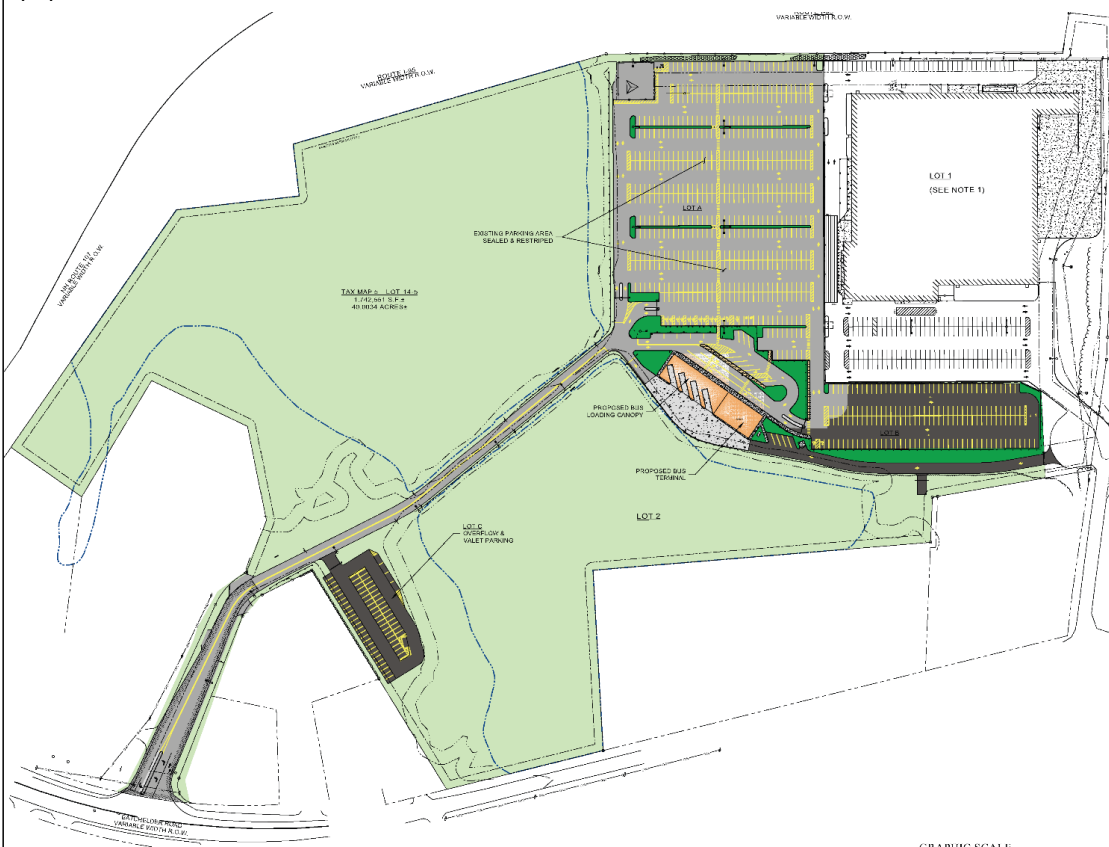

Civilworks Solves Problems

We enjoy challenges and look for creative and efficient solutions. It may be as simple as some basic wave forecasting or coastal resiliency advice for a permit application, up to design for multimillion dollar projects. We offer a comprehensive range of in-house civil, waterfront and coastal expertise.